

# Proposed Material Alterations to the Draft Letterkenny Plan 2023 - 2029, August 2023

To See the Original Map Content, Please refer to the Draft Land Use Zoning Map Published in January 2023.

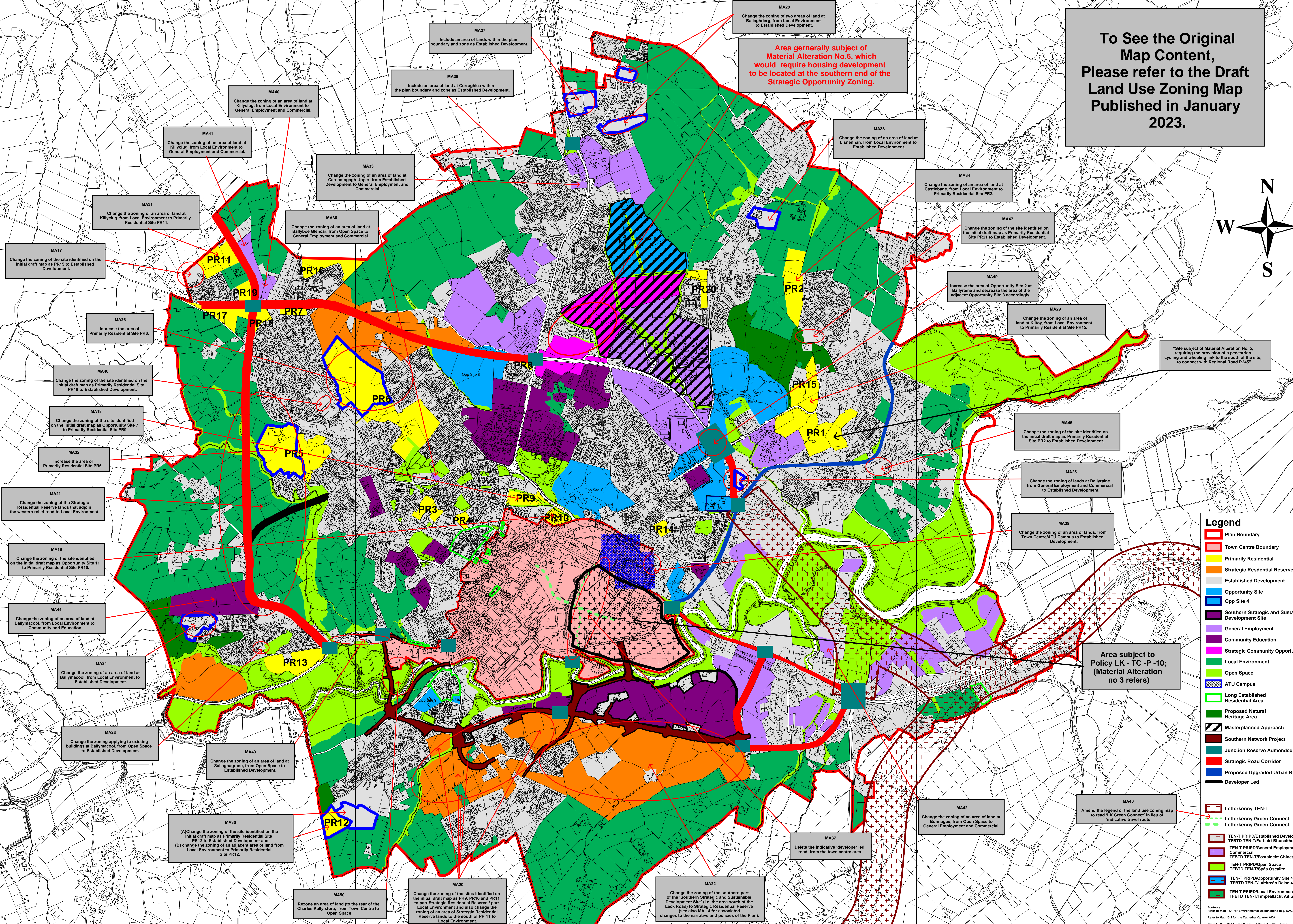
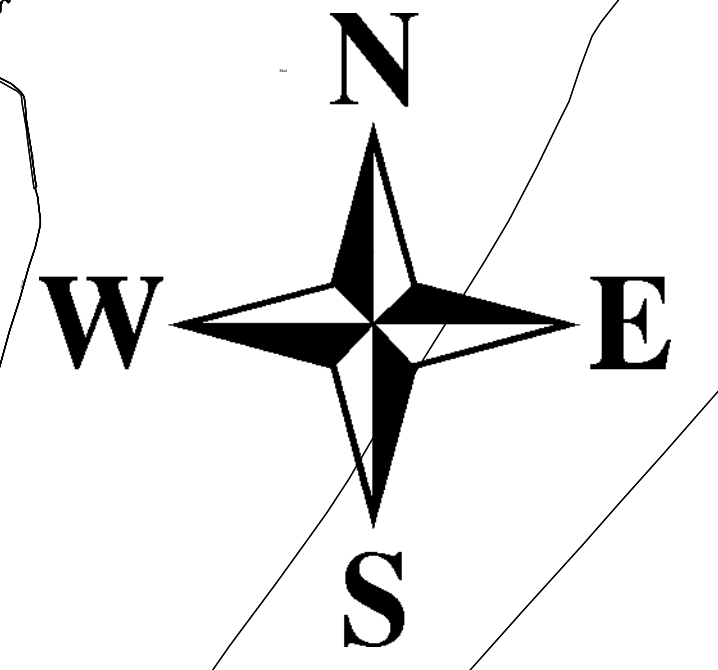

Area subject to Policy LK - TC - P -10; (Material Alteration no 3 refers)

### Legend

- Plan Boundary
- Town Centre Boundary
- Primarily Residential
- Strategic Residential Reserve
- Established Development
- Opportunity Site
- Opp Site 4
- Southern Strategic and Sustainable Development Site
- General Employment
- Community Education
- Strategic Community Opportunity
- Local Environment
- Open Space
- ATU Campus
- Long Established Residential Area
- Proposed Natural Heritage Area
- Masterplanned Approach
- Southern Network Project
- Junction Reserve Admended
- Strategic Road Corridor
- Proposed Upgraded Urban Roads
- Developer Led

- Letterkenny TEN-T
- Letterkenny Green Connect
- Letterkenny Green Connect
- TEN-T PR1P/Established Development
- TEN-T PR1P/General Employment
- TEN-T PR1P/Commercial
- TEN-T PR1P/Opportunity Site 4
- TEN-T PR1P/Opportunity Site 2
- TEN-T PR1P/Local Environment

Footnote:  
Refer to Map 13.1 for Environmental Designations (e.g. SAC, SPA, pNHA)  
Refer to Map 13.2 for the Cultural Quarter ACS  
Refer to Map 13.3 for the Record of Protected Structures